

Altoona Community
Garden plots are all
reserved for 2025.

Please check again in
January or February,
2026.

Thank you!

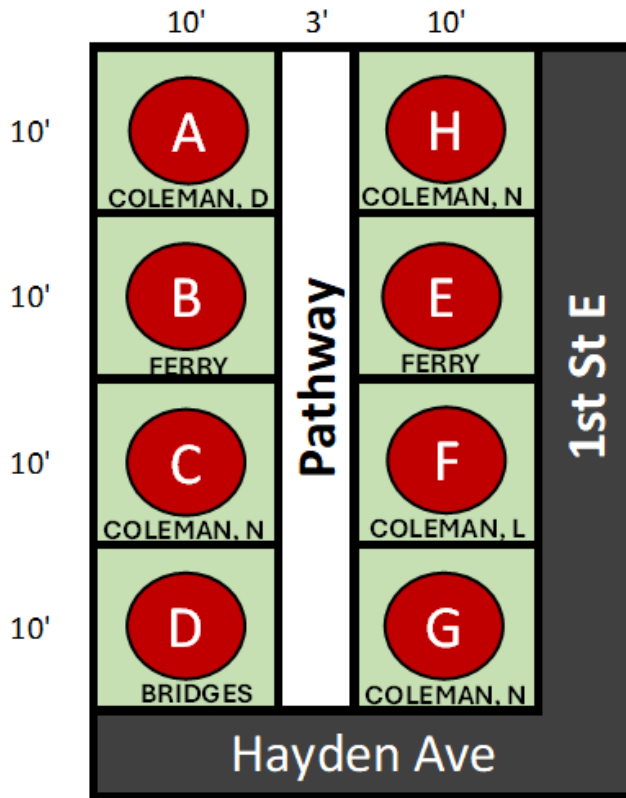

 CITY HALL COMMUNITY
 GARDEN 04.17.2025

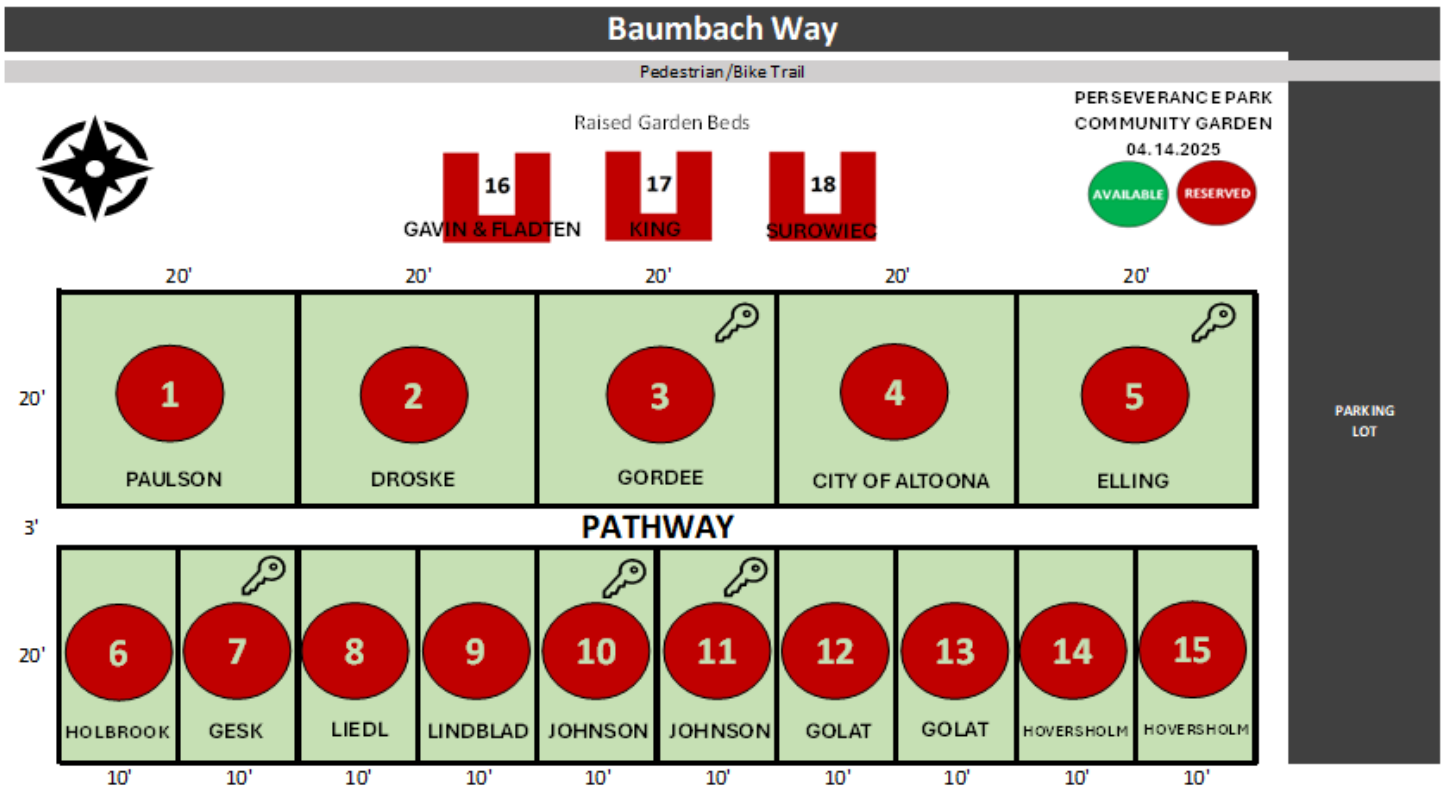

PLEASE PRINT

Name _____
 Address _____ City _____ Zip _____
 Daytime Ph # _____ Email Address _____

NEW GARDENERS: Processing of garden plot rental applications begins mid-February. Please submit your payment with this application. If all spaces are rented when you make your application, your payment will be returned to you. Garden plots are rented on a first come first served basis except for gardeners from the prior year. Returning gardeners are given the first opportunity to continue using their garden spots from the previous gardening season. In the chart below, please mark the garden location/size you would like in order of preference.

RETURNING GARDENERS: Processing of garden plot rental applications begins mid-February. Returning gardeners will have the first opportunity to continue their garden spots from the previous year and their plot will be reserved for them as soon as payment for the new garden season is received. The deadline to submit payment is March 1. If returning gardeners miss the payment deadline, their garden spot from last year will be listed as available for rent in the new season. In the chart below, please record your garden plot letter or number assigned to you during the previous garden season.

| Garden Name | Address | Plot Size | Fee | Preference |
|-------------------|------------------|------------|---------|------------|
| City Hall Garden | 1304 Hayden Ave | 10' x 10' | \$10.00 | |
| Perseverance Park | 205 Baumbach Way | Raised Bed | \$5.00 | |
| Perseverance Park | 205 Baumbach Way | 10' x 20' | \$15.00 | |
| Perseverance Park | 205 Baumbach Way | 20' x 20' | \$20.00 | |

Comments or special requests:

I agree to allow the City of Altoona to use my audio, video, and/or print images for publicity purposes: _____
 (please initial if you agree)

I hereby acknowledge I have read and understand the entirety of the attached guidelines, and by signing and dating this application, I acknowledge I will comply with the terms as stated. Failure to comply with these terms is the basis for cancellation of my garden permit.

Signature _____

Date _____

Please submit your application with your payment to: *cityhall@ci.altoona.wi.us* ,
 or mail or drop-off at Altoona City Hall, 1303 Lynn Avenue, Altoona, WI 54720.

Thank you!

FOR OFFICE USE ONLY

| | | | |
|---------------------------------------|-----------------|--------------------------|-----------|
| _____ | \$ _____ | _____ | _____ |
| Date Received | Amount Received | Check # or Cash | Receipt # |
| Accounting Code: 100-00-48300-000-000 | | | |
| Plot Number(s) assigned: _____ | | _____ | |
| City Hall Garden | | Perseverance Park Garden | |

Rules of the Row for City of Altoona Community Gardens

Disclaimer

City of Altoona, in permitting the use of certain excess lands for garden plots by the public, is not responsible for any personal injury or property damaged incurred by any plot renter, or for the theft, loss, or destruction of personal property owned by any plot renter.

Watering

Each gardener is responsible for providing their own watering supplies (hoses, pails, etc.). The City is not responsible for any stolen watering supplies.

Water is to be used in a responsible manner and shut off after usage. Any misuse or abuse of watering will result in revocation of watering and/or garden privileges. Misuse or abuse should be reported to the City of Altoona Office. Watering hoses may not remain hooked up to the water faucets after you leave for the day. Hoses must be used in the gardening area only. Mowing services may run over hoses, if they cannot see them.

Tools

Each gardener is responsible for providing their own gardening tools. Gardeners are also responsible for taking tools with them at the end of the day. The City is not responsible for any stolen gardening supplies.

Soil / Plot Enhancement

The soil at the garden plots is fairly sandy. Some people choose to add organic matter or fertilizers to improve the soil. However, this and any other enhancements to the plot do not privilege you to ownership, reimbursement of cost, or receipt of the same plot next year unless you choose to pay the plot fee before or on the named deadline on the application.

Basic Rules

Plantings in the garden are entirely the decision of the renter with these exceptions:

- Vines cannot spread into adjoining plots; planting may be only in rented plot.
- No illegal plants or other controlled substances shall be planted.
- Pets are not allowed in the garden area.
- Children are confined to the family's assigned plot(s) and must be supervised at all times.
- There are to be no fires for any reason at the gardens.
- Do not chop down seedling trees or branches from surrounding trees for stakes.
- The use of stereos is prohibited. If you like listening to music in the gardens, please use headphones.

Weed Control

- Each gardener is responsible for keeping the assigned plot free from weeds and obstacles. Not complying with the proper weed control may result in refusal of plot space in the future.
- Herbicide and insecticide use is permitted in the garden area. Please limit usage of herbicides/ insecticides to your own plot. Please also be courteous of the other plots and only apply herbicides/insecticides in conditions that are conducive to spraying (non-windy). Feel free to contact the City of Altoona Office with questions on pest management strategies.
- You will be contacted if your plot looks neglected or improperly cared for. If a solution cannot be found then the plot may be reassigned. If you need to give up your plot for any reason, notify the City of Altoona. Just abandoning your plot may result in forfeiting your opportunity to garden in the community garden site next year.

Trash

- Garden debris, weeds, rocks, sod, or other materials are not to be placed in other plots.
- ALL garbage is to be taken home for disposal. Nothing is to be left on site.
- If you use milk jugs to cover your tomato seedlings, be sure they are well-anchored to keep them from blowing away. Take them home when you are done using them.

Harvesting

Harvest only your own crops unless given permission by other plot owners to harvest their crops.

Surveillance

Altoona Community Garden plots will be under video surveillance.

End of Season

Complete fall clean-up of your garden plot(s) by October 31, 2024 and understand that failure to clean up your plot(s) will result in denial to participate in the community garden the following year. Remove all stakes, string, twine, plastic, trash, and anything else you brought to the gardens.

Keep in mind, the water at the garden may be turned off by early October, depending on the forecast.

General Information

Please be respectful of other gardeners and their plots. Disrespectful language or destructive behavior is not allowed.

Questions about the City of Altoona Community Garden plots may be directed to the City of Altoona at 715-839-6092. Garden rules are subject to change!